

# **User's Manual**

## **2 in 1 CORDLESS HANDSTICK VACUUM CLEANER**

Please read this User's Manual carefully for proper use of Midea Vacuum Cleaner.



# Safety Instructions

- It is hazardous for anyone other than a competent person to carry out any service or repair operation that involves the removal of a cover which gives protection against exposure to electrical parts.
- The appliance is only to be used with the power supply unit provided with the appliance. The plug must be removed from the socket-outlet before cleaning or maintaining the appliance.
- This appliance contains batteries that are only replaceable by skilled persons. Battery must be removed before scrapping appliance. Battery must be disposed of safely.
- **WARNING:** For the purposes of recharging the battery, only use the detachable supply unit provided with this appliance. (Adaptor model number: MC2805A-B)
- If the adapter cord is damaged, it must be replaced by the manufacturer, its service agent or similarly qualified persons in order to avoid a hazard. Do not use with damaged cord or plug. Do not run the vacuum cleaner over any cables, as this will result in damaging the cable.
- This appliance can be used by children aged from 8 years and above and persons with reduced physical, sensory or mental capabilities or lack of experience and knowledge if they have been given supervision or instruction concerning use of the appliance in a safe way and understand the hazards involved. Children should not play with the appliance. Cleaning and user maintenance should not be made by children without supervision.
- This product is intended for household use only. Do not use outdoors. Do not direct at people, animals, electrical outlets, or equipment containing electrical components.
- Unplug from outlet when fully charged, and before putting on and taking off parts, and before cleaning. Do not leave the cleaner unattended while plugged in.
- Do not use vacuum cleaner if it has been dropped, damaged, left outdoors or dropped into water. Do not operate this appliance for anything other than its intended use.
- Keep the vacuum cleaner and adapter away from water; do not allow it to get wet. If unit is wet, do not plug unit into wall socket or turn unit on. Do not immerse in water or other liquids for cleaning. Do not handle the vacuum cleaner with wet hands.
- The use of accessory attachments not recommended by the appliance manufacturer may cause fire, electric shock or injury. Only use the accessories supplied by the manufacturer. Only use the unit when fully assembled.
- Do not use this vacuum to pick up water or any other liquids, combustible substances or hot/burning objects. Never place your fingers or other objects into any part of the cleaner. Be aware that loose clothing or hair may become trapped in the cleaner if improperly used.

# Product Introduction

## What comes in the carton

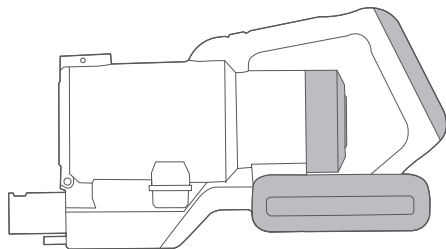

Hand vacuum

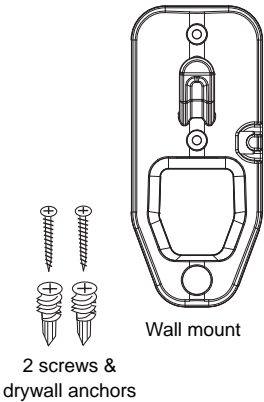

Wall mount

2 screws &  
drywall anchors



Crevice tool

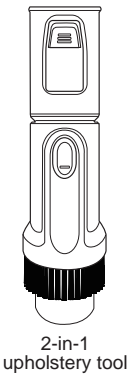

2-in-1  
upholstery tool

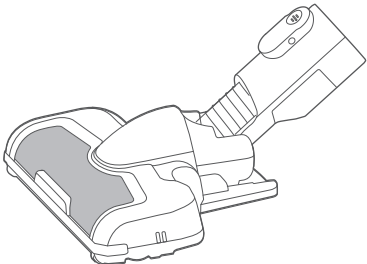

Motorized floor nozzle

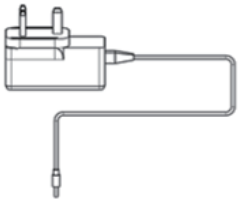

Charger

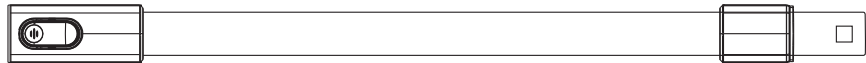

Wand

# Structure of the product

## Assembly and parts description

### Cordless vacuum cleaner

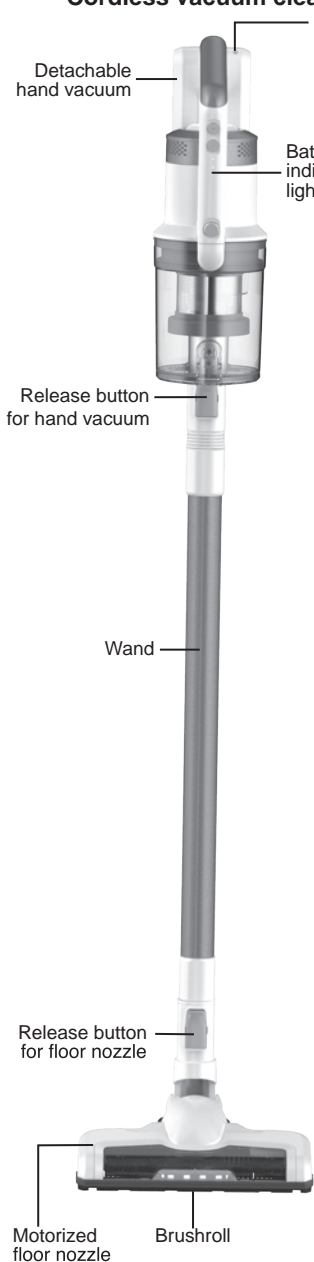

### Hand vacuum

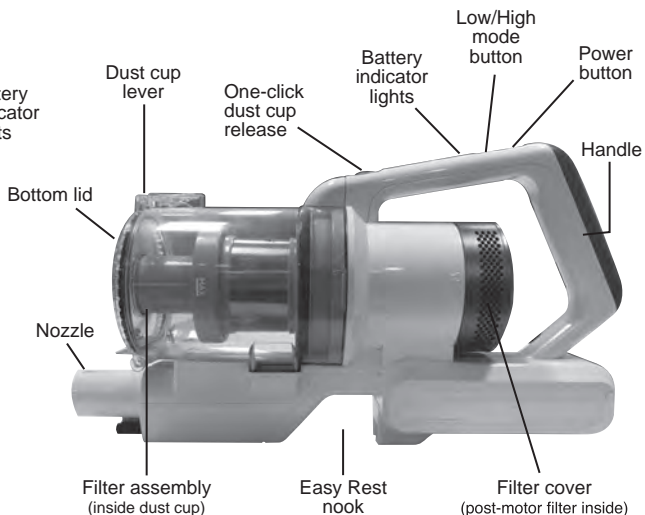

### For filter maintenance instructions, see page 9

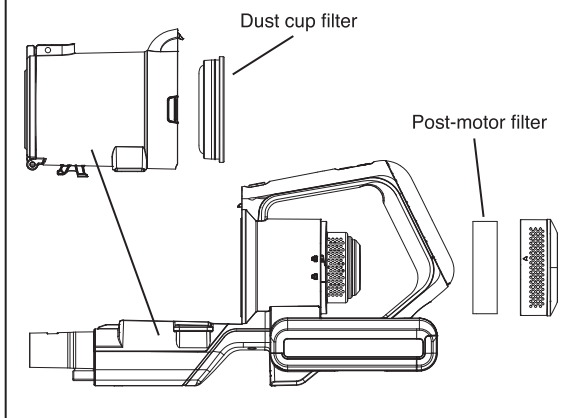



## Easy assembly

1. Slide the wand onto hand vacuum until it lock (Fig. 1).
2. Push the wand into motorized floor nozzle until it lock (Fig. 2).

### How to install wall mount

- Choose location near power outlet. Locate point high enough on wall to allow wand and motorized floor nozzle to hang freely.
- Place mount against wall and use pencil to mark drill holes.
- Drill holes (with 1/4" bit) and insert drywall anchors. Insert screws through holes on mount and tighten until firmly attached (Fig. 3).

### How to charge battery and store accessories

- Place assembled vacuum cleaner on wall mount.
- Plug charger into power outlet and then into charger port on handle (Fig. 4).
- Loop charger cord into clips on sides of wall mount.

### Battery indicator lights show level of charging (Fig.4):

- A. Half charged
- B. Fully charged

- Indicator lights stop blinking when fully charged.
- Charge battery fully before using for the first time. This may take up to six hours.

Fully charge the battery for six hours before first use.

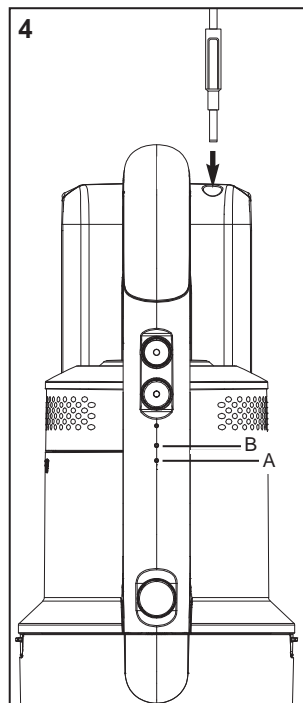
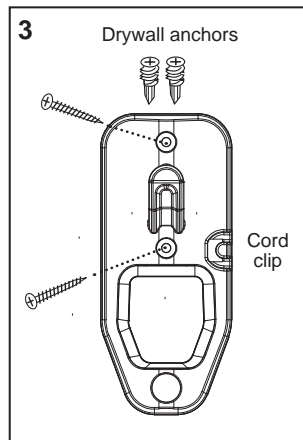
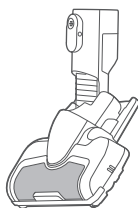
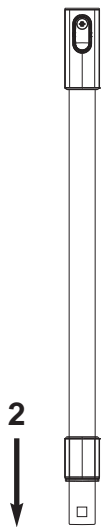
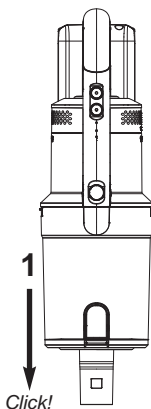

## How to use cleaner for sweeping

1. Click power button once to start (Fig 1).  
Vacuum starts on High mode. Choose Low/High button to switch between modes.
2. Using motorized floor nozzle, glide back and forth on area to be cleaned. Avoid oversized or sharp items (such as screws) with cleaner.
3. Twist wrist to engage swivel function.
4. When done, click power button once to stop motor.

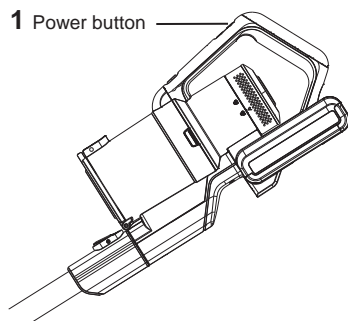

## Empty dust cup after every use

1. Click the dust cup release button, located on the front of the handle just above the dust cup and pull dust cup out. (Fig. 2).
2. Press lever to release bottom lid of dust cup to empty debris. (Fig. 2)
3. To place the dust cup back, angle it forward so the lower hook catches in the slot and then gently push it back towards the wand until you hear click indicating it is locked in place. (Fig. 3)

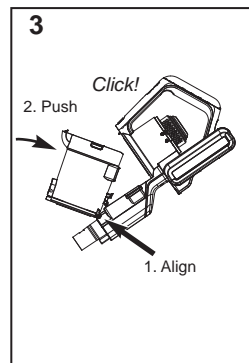
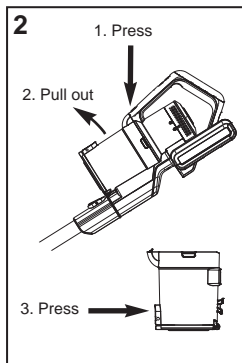

## How to use hand vacuum and accessories

### ⚠ CAUTION

**Moving parts!** Always turn off hand vacuum before attaching accessories.

The hand vacuum can be used with or without tools.

- To use without tools, press release button and remove wand. Collect debris directly with hand vacuum nozzle (Fig. 4).
- To use tools with wand, press release button to remove motorized floor nozzle. Slide tool onto end of wand until it lock (Fig. 5).
- To use tools with hand vacuum only, press release button to remove wand. Slide tool onto hand vacuum until it lock.

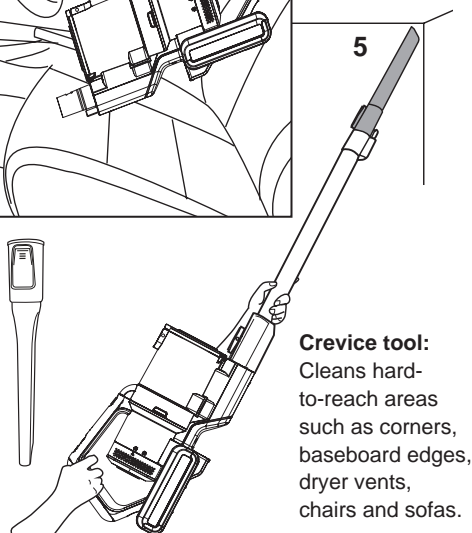
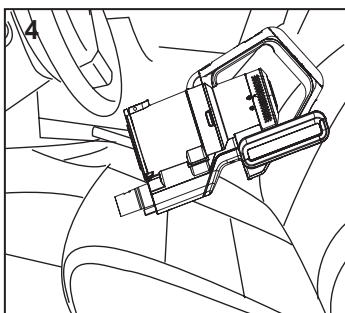

**Crevice tool:**  
Cleans hard-to-reach areas such as corners, baseboard edges, dryer vents, chairs and sofas.

Use with or without wand.

- **2-in-1 upholstery tool:** Use brush to vacuum blinds, vents or upholstered surfaces. Use felt portion to clean delicate surfaces. To switch between felt and brush portions, press thumb release and slide brush up or down.

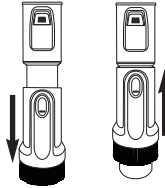
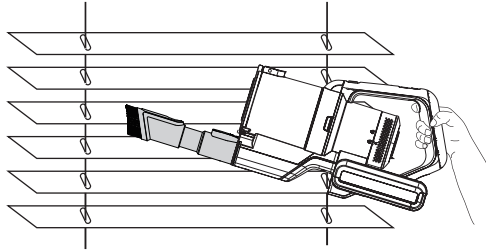

## How to use hand vacuum and motorized floor nozzle

Ideal for cleaning stairs.

- Press release button to remove wand from hand vacuum. Attach motorized floor nozzle directly to hand vacuum until it lock.
- Click power button once to start. Vacuum starts on High mode. Choose Low/High button to switch between modes depending on suction power desired.

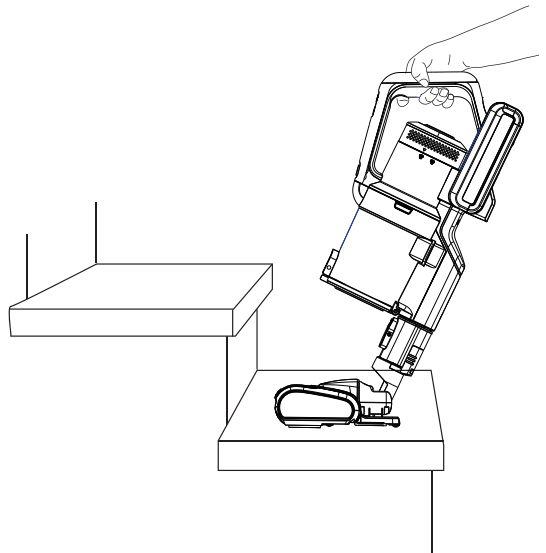

# Cleaning and Maintenance

## ⚠ CAUTION

Do not operate vacuum cleaner without all filters. Filter Screen and dust cup should be in proper position.

**WARNING:** Moving parts!

Recharge cleaner after each use.

## Dust cup – Empty after each use

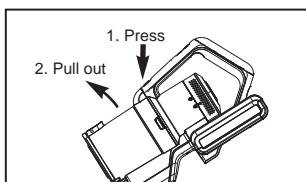

Click the dust cup release button, located on the front of the handle just above the dust cup and pull dust cup out.

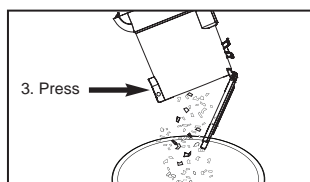

Press lever to release bottom lid of dust cup to empty debris.

## Washable dust cup filter – clean monthly

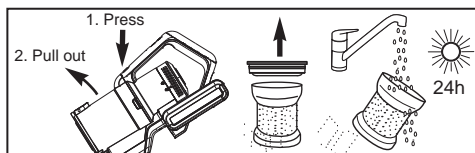

1. Click the dust cup release button, located on the front of the handle just above the dust cup and pull dust cup out.
2. Lift out pre-motor filter and shake off dust frequently. Every three months rinse filter and dry THOROUGHLY.
3. Reattach filter and Cyclone.
4. Click dust cup back into place on unit.

## Washable post-motor filter – clean every 6 months

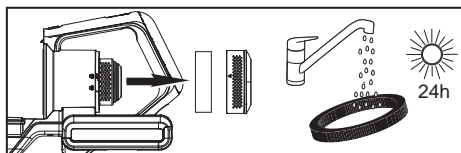

1. Twist filter cover and remove.
2. Lift out post-motor filter.
3. Shake to remove dust.
4. Every 6 months, replace filter or rinse and dry THOROUGHLY.
5. Reposition filter and cover and twist to 'lock.'

## How to maintain brushroll

To avoid unnecessary service calls, periodically check brushroll for debris. If brushroll gets clogged it will automatically shut off. Turn vacuum off and unplug before attempting to remove clog.

## Washable brushroll – clean frequently

### ⚠ CAUTION

Make sure vacuum cleaner is turned off and not plugged into a power source.

**WARNING:** Do not attempt to remove belt.

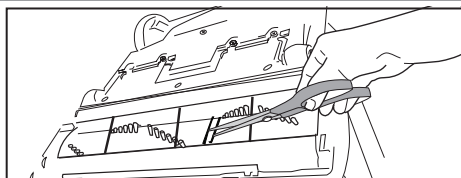

Step on floor nozzle to lower handle. Turn vacuum face down on floor. Use scissors to clip heavy threads or strings.

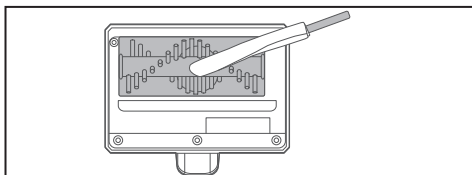

If debris cannot be removed easily, locate the brushroll release tab on the right side and open the brushroll cover. Remove the brushroll and clear any tangled hair and remaining debris.

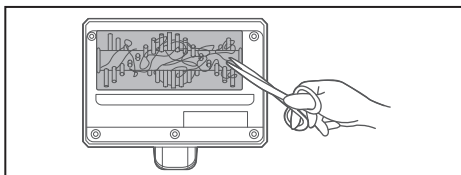

To reassemble:

1. Align one end of brushroll with floor nozzle gear.
2. Press other end into slot.
3. Replace brushroll release tab into slot and press down to click it into place.









The design and specifications are subject to change  
without prior notice for product improvement.  
Consult with your dealer or manufacturer for details.

A quality product of



CONCEPCION MIDEA INC.



**Midea Customer Care**  
Email: [customercare@midea.com.ph](mailto:customercare@midea.com.ph)  
Toll free: 1-800-10-863-5522  
Landline: (02) 8863-55-22  
Viber/SMS: (0917) 863-5522  
Monday - Sunday / 8:00am - 8:00pm

For more information, please visit our website [www.midea.com.ph](http://www.midea.com.ph)