

**AIR PURIFIER**

# **USER MANUAL**

**MAP400GPBPWH**

Warning notices: Before using this product, please read this manual carefully and keep it for future reference. The design and specifications are subject to change without prior notice for product improvement. Consult with your dealer or manufacturer for details. The diagram above is just for reference. Please take the appearance of the actual product as the standard.

**THANK YOU LETTER**

Thank you for choosing Midea! Before using your new Midea product, please read this manual thoroughly to ensure that you know how to operate the features and functions that your new appliance offers in a safe way.

**CONTENTS**

**THANK YOU LETTER** ..... 01

**SAFETY INSTRUCTIONS** ..... 02

**SPECIFICATIONS** ..... 05

**PRODUCT OVERVIEW** ..... 06

**PRODUCT INSTALLATION** ..... 07

**QUICK START** ..... 08

**OPERATION INSTRUCTIONS** ..... 09

**CLEANING AND MAINTENANCE** ..... 11

**TROUBLESHOOTING** ..... 15

**TRADEMARKS, COPYRIGHTS AND LEGAL STATEMENT** 16

**DATA PROTECTION NOTICE** ..... 17

# SAFETY INSTRUCTIONS

## Intended Use

The following safety guidelines are intended to prevent unforeseen risks or damage from unsafe or incorrect operation of the appliance. Please check the packaging and appliance on arrival to make sure everything is intact to ensure safe operation. If you find any damage, please contact the retailer or dealer. Please note modifications or alterations to the appliance are not allowed for your safety concern. Unintended use may cause hazards and loss of warranty claims.

## Explanation of Symbols



### **Danger**

This symbol indicates that there are dangers to the life and health of persons due to extremely flammable gas.



### **Warning of electrical voltage**

This symbol indicates that there is a danger to life and health of persons due to voltage.



### **Warning**

The signal word indicates a hazard with a medium level of risk which, if not avoided, may result in death or serious injury.



### **Caution**

The signal word indicates a hazard with a low degree of risk which, if not avoided, may result in minor or moderate injury.



### **Attention**

The signal word indicates important information (e.g. damage to property), but not danger.



### **Observe instructions**

This symbol indicates that a service technician should only operate and maintain this appliance in accordance with the operating instructions.

Read these operating instructions carefully and attentively before using/commissioning the unit and keep them in the immediate vicinity of the installation site or unit for later use!



## **CAUTION**

- Read rules for safe operation and instructions carefully.
- The appliance must be disconnected from the supply mains before cleaning or other maintenance.
- This appliance is not intended for use by persons (including children) with reduced physical, sensory or mental capabilities, or lack of experience and knowledge, unless they have been given supervision or instruction concerning use of the appliance by a person responsible for their safety. Children should be supervised to ensure that they do not play with the appliance.
- Indoor and household use only.
- When the appliance is not in use and before cleaning, unplug the appliance from the outlet.
- Please use the original filter provided by the factory. In case of other filters, the best results cannot be achieved.
- Do not insert the fingers or objects into the air inlets or air outlets to prevent the product from physical damages or malfunction.
- Please unplug the power cord immediately and contact the service center in time when the appliance suffers abnormal sound or burnt smell or smoke.
- This appliance cannot replace natural ventilation and other appliances like the vacuum cleaner, kitchen ventilator, etc.
- When the appliance is working, it must be placed on a dry, flat and stable floor, with at least 30cm space reserved around it.
- The mist produced by the ultrasonic humidifier may affect the PM2.5 detection of this appliance, and both should maintain a certain distance.

## **⚠ WARNING**

- If the supply cord is damaged, it must be replaced by the manufacturer, its service agent or similarly qualified persons in order to avoid a hazard.
- Do not block the air inlets/outlets of the appliance with any item.
- To protect against the risk of electrical shock, do not immerse the unit, cord or plug in water or other liquid.
- Do not place other items on top of the appliance, and forbid sitting or standing on this appliance.
- Do not spray flammable substances near the appliance; Do not spray water directly on the appliance or use chemical cleaners like alcohol or hydrochloric acid, etc.; Do not place water containers, medicines, or flammable materials on the appliance.
- Do not put it in a place with direct sunlight.
- To prevent electromagnetic disturbance, the appliance must keep a certain distance from the TV, radio, microwave oven and others.
- Do not disassemble or modify this appliance without authorization to avoid accidents.
- Do not pull the adapten cable to move the appliance.
- The appliance is only to be used with the power supply unit provided with the appliance.
- **WARNING:** To reduce the risk of fire or electric shock, do not use this fan with any solid-state speed control device.
- Do not operate any fan with a damaged cord or plug. Discard fan or return to an authorized service facility for examination and/or repair.
- Do not run cord under carpeting. Do not cover cord with throw rugs, runners, or similar coverings. Do not route cord under furniture or appliances. Arrange cord away from traffic area and where it will not be tripped over.

# SPECIFICATIONS

Product Model	MAP400GPBPWH
Operating Voltage	24V $\equiv$
Rated Power	35W
CADR (particulate matter)	380m <sup>3</sup> /h
Noise	35-65dB(A)
Usable Area	27-46m <sup>2</sup>

Accessory	Power adapter
Input	100-240V~ 50/60Hz 1.5A
Output	24V $\equiv$ 1.5A

- The performance parameters listed in the table are measured at the factory and are for reference only.
- Due to product improvements, the parameters may be subject to change. Please refer to the product nameplate for the specific parameters.
- The applicable area is calculated based on the theoretical value of (0.07-0.12) multiplied by the CADR of particulate matters. However, the applicable area may vary depending on factors such as the environmental conditions and indoor pollution levels.
- Purification principle: The air purifier's fan draws in air and filters it through the built-in filter, primarily removing dust particles (such as PM2.5) for purification purposes.

# PRODUCT OVERVIEW

## Part Name

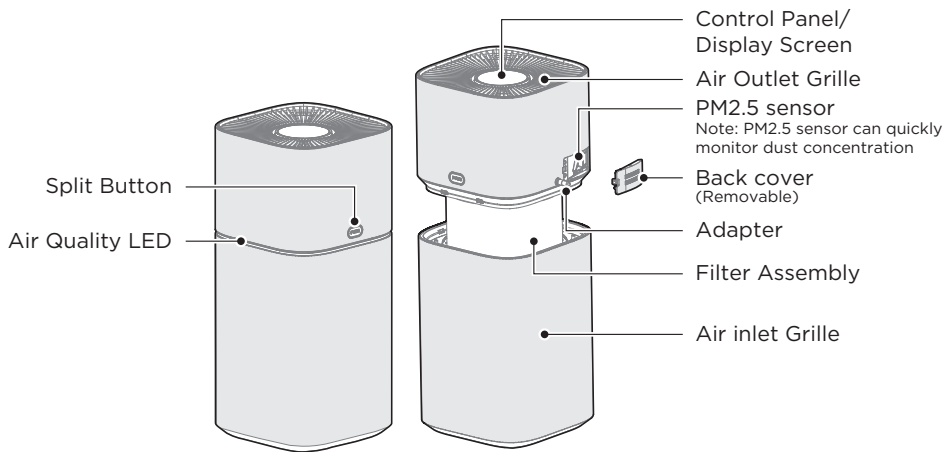

## Part List

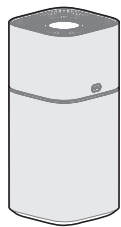

Main unit x1

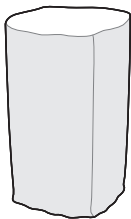

Packaging bag x2

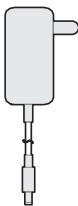

Adapter x1

### NOTE

All the pictures in this manual are for explanation purpose only. Any discrepancy between the real object and the illustration in the drawing shall be subject to the real subject.

# PRODUCT INSTALLATION

## Installation Steps

- 1 Take out the filter and remove the packaging bag.

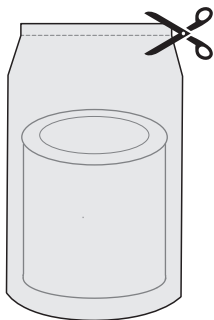

- 2 Install the filter assembly.

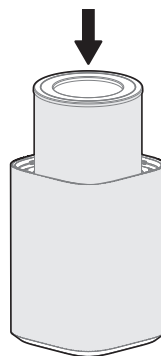

- 3 Gently place the upper part of the purifier down.

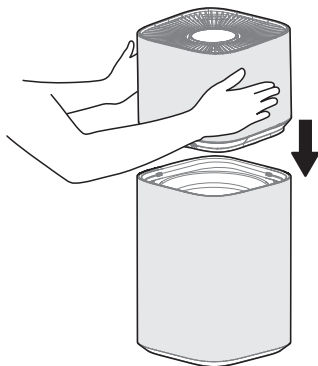

- 4 Plug the power adapter to power on.

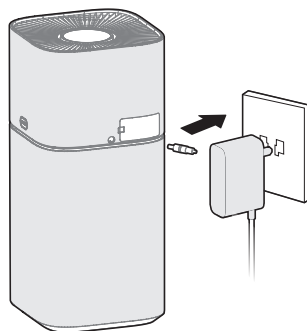

# QUICK START

## Test Run

### NOTE

- The machine enters the working mode before the standby state every time it is switched on without power supply.
- After an accidental power failure (e.g. power failure at home or unplugging the power cord for normal operation) and re-powering, it automatically resumes the working state before the power failure.

- 1 Plug in the power adapter and then connect it to the power source.

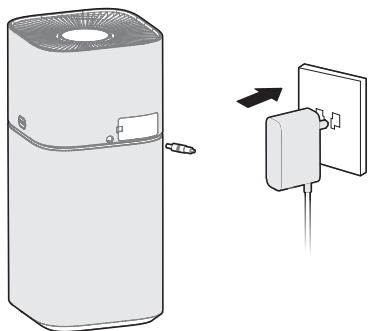

- 2 When powered on for the first time, the display panel will flash for 1 second and then turn off, entering the standby mode.

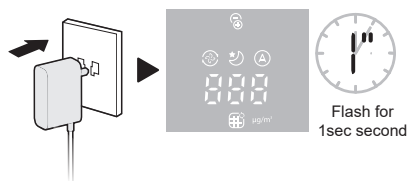

### 3 Power/Standby

Press the Power/Standby button to turn on the standby mode



### 5 Working

The purifier will enter the auto mode after initial power-on.



### 4 Preheat







The particulate matter sensor enters the preheating state. The air quality LED will turn on after 10 seconds and enter normal operation.

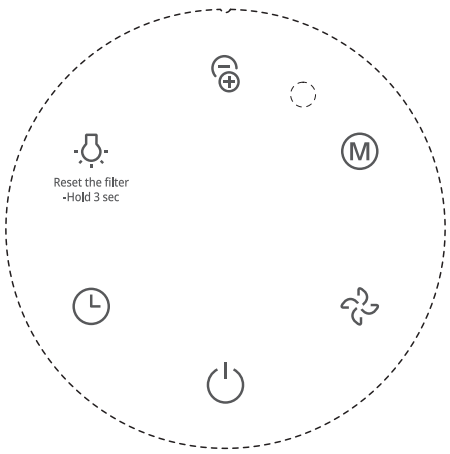

# OPERATION INSTRUCTIONS







## Control Panel



Button	Function description
 Power/Standby button	<ul style="list-style-type: none"><li>• Power on or enter standby mode.</li></ul>
 Ionizer button	<ul style="list-style-type: none"><li>• Activate/deactivate the ionizer function, Note: The ionizer function is designed to neutralize harmful substances such as airborne mold and viruses in the air, thus achieving air purification effects.</li></ul>
 Mode Switch button	<ul style="list-style-type: none"><li>• Switch the operating mode to Extreme Speed mode, Sleep mode, and Auto mode.</li></ul>
 Ionizer button	<ul style="list-style-type: none"><li>• Adjustable wind speed from level 1 to 12.</li></ul>
 Ionizer button	<ul style="list-style-type: none"><li>• Adjust button backlight brightness and ambient light switch.</li><li>• Air quality LED Blue—Excellent air quality; Green - Good air quality; Orange - Moderate air quality; Red - Poor air quality;</li></ul>
 Ionizer button	<ul style="list-style-type: none"><li>• Set timer power on/off function.</li></ul>

Display Panel



Display	Description
	<ul style="list-style-type: none"><li>• Ionizer LED.</li></ul>
	<ul style="list-style-type: none"><li>• Turbo Mode LED.</li></ul>
	<ul style="list-style-type: none"><li>• Sleep mode LED.</li></ul>
	<ul style="list-style-type: none"><li>• Auto mode LED adjusts the wind speed automatically based on air quality.</li></ul>
	<ul style="list-style-type: none"><li>• Comprehensive display area.</li></ul>
	<ul style="list-style-type: none"><li>• When the filter replacement LED is ON continuously, it reminds the user to replace the filter. Please refer to the subsequent filter component replacement steps to complete the filter replacement.</li></ul>
	<ul style="list-style-type: none"><li>• The dust sensor detects the concentration of particulate matter (PM2.5) in the air : unit.</li></ul>



# CLEANING AND MAINTENANCE

## Body Cleaning

### 1 Main unit

Wipe the body with a soft towel.

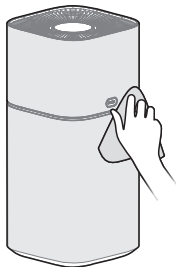

### 2 Body interior

Press the "PUSH" button on the body and lift the upper part of the air purifier. Use a vacuum cleaner to remove dust or wipe with a cloth.

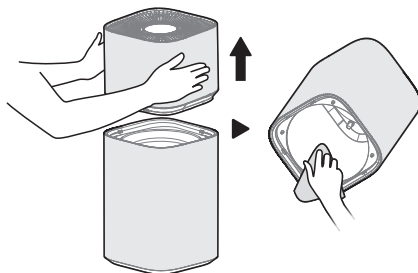

### 3 Vent grille

Use a vacuum cleaner to remove dust or wipe with a cloth.

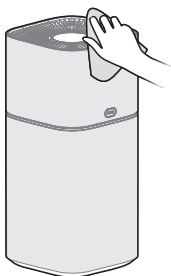

## Cleaning the dust sensor

### 1 Open the back cover.

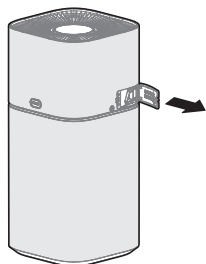

2 Use a vacuum cleaner to remove dust from the sponge inside the back cover, and then use a cotton swab to clean the vent of the dust sensor.

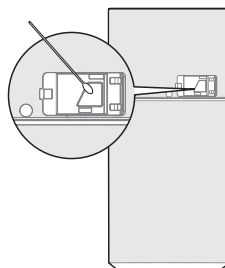

## Regular Maintenance for the Machine

1 When the air purifier is not in use for a long period of time, it is recommended to store the entire unit in a packaging bag to prevent dust from contaminating the filters.

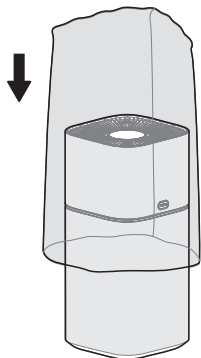

2 After removing the filters from the packaging bag, it is advised to regularly run the air purifier to keep the filters dry and prevent the growth of bacteria or unpleasant odors.

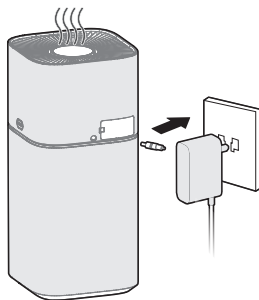

## Filter Cleaning & Replacement

### ● NOTE

- Before performing any maintenance operation, please make sure to turn off the air purifier and disconnect the power supply.

1 Unplug the air purifier and remove the filter components.

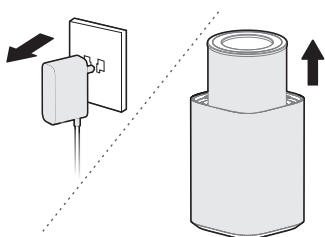

2 Use a vacuum cleaner to remove dust or wipe with a dry cloth.



- 3** Dampen the intake grilles and gently brush the surface of the grilles with a soft-bristle brush dipped in kitchen detergent to clean off any accumulated dust.

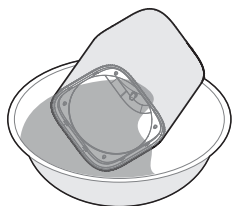

- 4** Rinse the inlet grilles thoroughly with clean water.

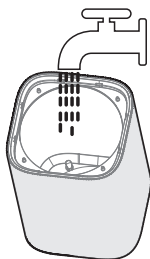

- 5** Allow the inlet grilles to air dry until no liquid is draining out.

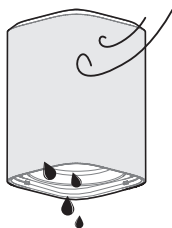

- 6** Install the filter components.

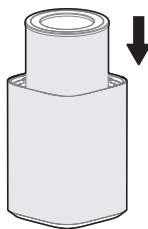

- 7** After properly installing the entire unit, plug in the air purifier and turn it on.

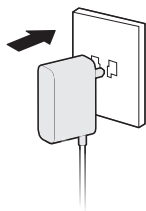

- It is recommended to clean the filters every two weeks and replace them every six months;
- Do not wash the filters with water.
- When cleaning the filters, it is advisable to use a smaller, soft brush or a household vacuum cleaner.
- When using a brush, brush horizontally along the filters, avoiding brushing vertically to prevent damage to the filters.
- When using a vacuum cleaner for cleaning, maintain a distance of 5-10mm between the suction inlet and the surface of the filters to avoid damaging them.
- The filters act as collectors for air pollutants, and severe pollution can accelerate the development of unpleasant odors. The filter replacement frequency can be adjusted based on the usage environment.

## Replacement of Filter Components

1 Filter model: FC-40Z2

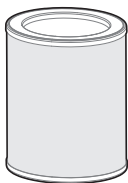

3 Replace the old filter with a new one.

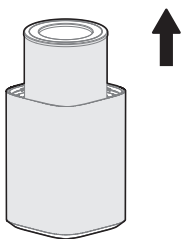

2 When the filter replacement LED is ON, it indicates that the filter needs to be replaced.



4 Press and hold the light button for 3 sec to reset the filter. The filter replacement LED will turn off.



Press and hold for 3 sec

# TROUBLESHOOTING

Operation of your appliance can lead to errors and malfunctions. The following tables contain possible causes and notes for resolving an error message or malfunction. It is recommended to read the table below carefully in order to save your time and money that may cost for calling to the service center.

Problem	Cause	Solution
The machine does not work properly after installed	• The power cable is not plugged in or has poor contact.	Make sure the plug is properly inserted into the socket.
	• The switch on the body is not turned on.	Turn on the switch on the body.

# TRADEMARKS, COPYRIGHTS AND LEGAL STATEMENT

 Midea logo, word marks, trade name, trade dress and all versions thereof are valuable assets of Midea Group and/or its affiliates ("Midea"), to which Midea owns trademarks, copyrights and other intellectual property rights, and all goodwill derived from using any part of an Midea trademark. Use of Midea trademark for commercial purposes without the prior written consent of Midea may constitute trademark infringement or unfair competition in violation of relevant laws.

This manual is created by Midea and Midea reserves all copyrights thereof. No entity or individual may use, duplicate, modify, distribute in whole or in part this manual, or bundle or sell with other products without the prior written consent of Midea.

All the described functions and instructions were up to date at the time of printing this manual. However, the actual product may vary due to improved functions and designs.

# DATA PROTECTION NOTICE

For the provision of the services agreed with the customer, we agree to comply without restriction with all stipulations of applicable data protection law, in line with agreed countries within which services to the customer will be delivered, as well as, where applicable, the EU General Data Protection Regulation (GDPR).

Generally, our data processing is to fulfil our obligation under contract with you and for product safety reasons, to safeguard your rights in connection with warranty and product registration questions. In some cases, but only if appropriate data protection is ensured, personal data might be transferred to recipients located outside of the European Economic Area.

Further information are provided on request. You can contact our Data Protection Officer via **MideaDPO@midea.com**. To exercise your rights such as right to object your personal data being processed for direct marketing purposes, please contact us via **MideaDPO@midea.com**. To find further information, please follow the QR Code.



*make yourself at home*



[www.midea.com](http://www.midea.com)



[www.facebook.com/midea.sg](https://www.facebook.com/midea.sg)

© Midea 2024 all rights reserved