

**Chest Freezer**  
**MECHANICAL CONTROL SERIES**

# **USER MANUAL**

**MERC05C2BAWW**

Warning notices: Before using this product, please read this manual carefully and keep it for future reference. The design and specifications are subject to change without prior notice for product improvement. Consult with your dealer or manufacturer for details.  
The diagram above is just for reference. Please take the appearance of the actual product as the standard.



## THANK YOU LETTER

Thank you for choosing Midea! Before using your new Midea product, please read this manual thoroughly to ensure that you know how to operate the features and functions that your new appliance offers in a safe way.

# CONTENTS

THANK YOU LETTER .....	01
SPECIFICATIONS .....	02
PRODUCT OVERVIEW .....	03
PRODUCT INSTALLATION .....	04
OPERATION INSTRUCTIONS .....	06
CLEANING AND MAINTENANCE .....	09
TROUBLESHOOTING .....	10

# SPECIFICATIONS

Product model	MERC05C2BAWW
Freezer Storage Volume	5.1 cu.ft. (143 L)
Rated Voltage	115V-
Rated Frequency	60Hz
Refrigerant, Amount	R600a,1.52oz(43g)
Product Dimension ( W x D x H)	23.6x22.0x33.5 in

# PRODUCT OVERVIEW

## Names of components

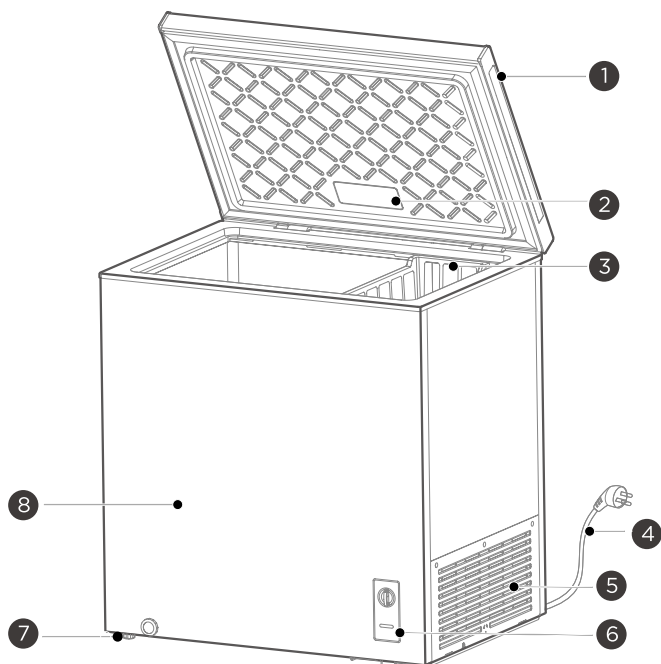

- |   |                           |   |                |
|---|---------------------------|---|----------------|
| 1 | Door handle               | 7 | Levelling foot |
| 2 | Lamp                      | 8 | Cabinet        |
| 3 | Shelving basket           |   |                |
| 4 | Power cord                |   |                |
| 5 | Shutter                   |   |                |
| 6 | Temperature control panel |   |                |

### ATTENTION

Images shown here are intended as examples only.

EN

# PRODUCT INSTALLATION

## Install Instruction

### Finding a suitable location

- This freezer is designed to be free standing only, and should not be recessed or built-in.
- The freezer should be placed in a well-ventilated indoor place; the ground shall be flat and sturdy .
- Keep away from heat and avoid direct sunlight. Do not place the freezer in moist or watery places to prevent rust or reduction of insulating effect.

### Dimensions and Clearances

- Too small of a distance from adjacent items may result in the degradation of freezing capability and increased electricity costs. Allow over 100 mm of clearance from each adjacent wall when installing the appliance.

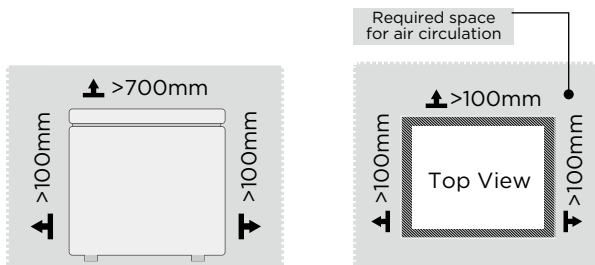

### ATTENTION

The picture above is only for reference. The actual configuration will depend on the physical product or statement by the distributor.

### Providing a proper power supply

- Check your local power source. This freezer requires a **AC115 V, 60 Hz** power supply.
- Use a receptacle that accepts the grounding prong. The power cord is equipped with a 3-prong (grounding) plug which mates with a standard 3-prong (grounding) wall outlet to minimize the possibility of electric shock hazard from this freezer.

### CAUTION

The freezer should always be plugged into its own individual electrical outlet which has a voltage rating that matches the rating plate.

Never unplug your freezer by pulling on the power cord. Always grip the plug firmly and pull straight out from the outlet.

### Start to use

- The freezer shall stay for half an hour before connecting power when it is firstly started.
- The freezer shall run 2 to 3 hours before loading fresh or frozen foods; the freezer shall run for more than 4 hours in summer in advance considering that the ambient temperature is high.

## Connecting the appliance

After installing the appliance, connect the power plug into a socket outlet.

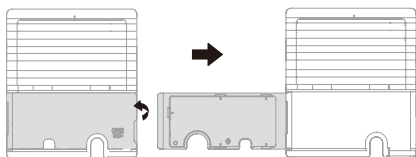

1. Open the cover plate from the side with the tool.
2. Operate the cover plate, take out the power cord, and then cover the cover plate.

### ATTENTION

After connecting the power supply cord (or plug) to the outlet, wait 2 or 3 hours before you put food into the appliance. If you add food before the appliance has cooled completely, your food may spoil.

## Changing the light (optional)

- Any replacement or maintenance of the LED lamps is intended to be made by the manufacturer, its service agent or similar qualified person.

# OPERATION INSTRUCTIONS

## Control panel

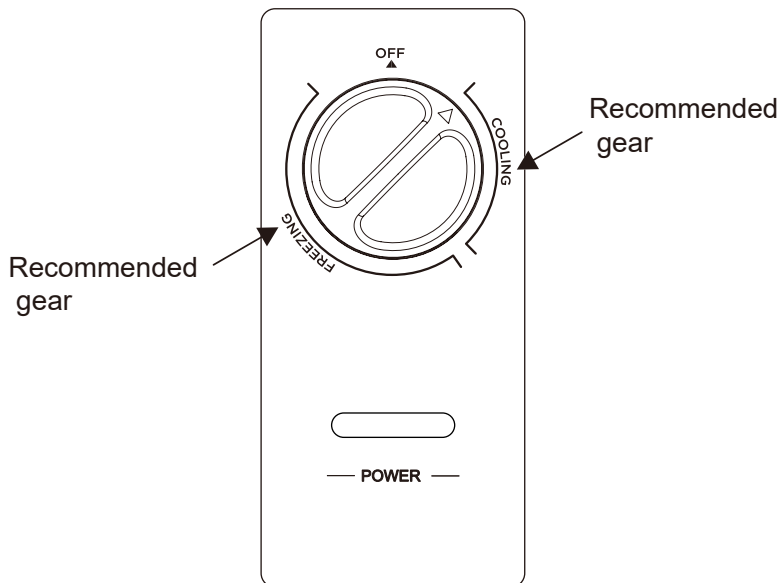

- After power on the "POWER" indicator light will be light.
- The area where the temperature controller knob points to "COOLING" is the refrigeration area, and "FREEZING" is the frozen area;
- When the temperature controller knob is turned clockwise, the temperature inside the freezer decreases;
- When the temperature controller knob is turned counterclockwise, the temperature inside the freezer increases;
- At the OFF position: turn off the freezer;
- Please refer to the schematic diagram to identify the "recommended gear".

(The picture above is only for reference. The actual configuration will depend on the physical product or statement by the distributor)



## Warnings for energy

1. Freezer might not operate consistently when sited for an extended period of time below the cold end of the range of temperatures for which the freezer appliance is designed.
2. The fact that effervescent drinks should not be stored in food freezer compartments or cabinets or in low-temperature compartments or cabinets, and that some products such as water ices should not be consumed too cold;
3. The need to not exceed the storage time recommended by the food manufacturers for any kind of food and particularly for commercially quick-frozen food in food-freezer and frozen-food storage compartments or cabinets;
4. The precautions necessary to prevent an undue rise in the temperature of the frozen food while defrosting the refrigerating appliance, such as wrapping the frozen food in several layers of newspaper.
5. The fact that a rise in temperature of the frozen food during manual defrosting, maintenance or cleaning could shorten the storage life.
6. The necessity that, for doors or lids fitted with locks and keys, the keys be kept out of the reach of children and not in the vicinity of the freezer appliance, in order to prevent children from being locked inside.

## Energy saving tips

- The appliance should be located in the coolest area of the room, away from heat producing appliances or heating ducts, and out of the direct sunlight.
- Let hot foods cool to room temperature before placing in the appliance. Overloading the appliance forces the compressor to run longer. Foods that freeze too slowly may lose quality, or spoil.
- Be sure to wrap foods properly, and wipe containers dry before placing them in the appliance. This cuts down on frost build-up inside the appliance.
- Appliance storage bin should not be lined with aluminum foil, wax paper, or paper toweling. Liners interfere with cold air circulation, making the appliance less efficient.
- Organize and label food to reduce door openings and extended searches. Remove as many items as needed at one time, and close the door as soon as possible.

## Tips on storing food

- The low temperature of freezer may keep food fresh for a long time and it is mainly used to store frozen foods and making ice.
- The freezer is suitable for storage of meat, fish, shrimp, pastries class and other foods not to be consumed in short term. Do not store fluids in bottled or closed containers Items such as bottled beer, beverages, etc.
- It is not suitable to store bottled or closed containers of fluid items for a long time, if you want to store bottled or closed containers of fluid items, the stored items should not be close to the wall of the freezer.
- There is a certain deviation between the temperature inside the box and the actual setting temperature, which does not affect normal use.
- Please be noted food shall be consumed within the shelf time.

### ATTENTION

- After long term using, there maybe a certain degree of wear with the hinge, it will cause the noise when open/close the door and reduce the service life of hinge. It is recommended to put the grease on hinge for maintenance regularly, it can effectively eliminate noise and extend the service life of the hinge.
- The weight of the objects in the basket should not exceed 5 kg.
- If the product is packaged in thin film, there may be condensation on the surface of the box and the film when the temperature and humidity of the transportation environment change rapidly. This phenomenon is a normal physical phenomenon, does not affect the use of the product.

# CLEANING AND MAINTENANCE

Your freezer is designed for year-round use and requires minimal cleaning and maintenance. To keep your freezer running efficiently and odor free, we recommend that you clean the freezer regularly.

## Defrost

Freezer shall be manually defrosted.

- Unplug the freezer and open the freezer door, remove foods and shelving basket before defrosting; Open the outflow hole and drainage hole (and place water container at the outflow hole); indoor frost will naturally melt, wipe the defrost water with a dry, soft cloth. When the frost softens, an ice scraper might be used to the accelerate de-icing process.
- Please remove the food and put in a cool place when defrosting before removing accessories.

## Stop using

- Power failure: Foods can be preserved for a couple of hours even in summer in case of power failure; it is recommended to reduce the frequency of opening door and do not put fresh foods into the freezer.
- Long-time nonuse: Please unplug the freezer left unused for a long time for cleaning. Keep the door open to avoid the bad odor.
- Moving: Do not turn upside or vibrate the freezer, the carrying angle can not be greater than 45°. Do not hold the door and hinge when moving this unit.

EN

## ATTENTION

- Other mechanical devices or other means shall not be used to accelerate except those recommended by the manufacturer. Do not damage the refrigerant circuit.
- Continuous operation is recommended when the freezer is started. Please do not stop the freezer under normal circumstances so as not to affect the freezer's service life.

# TROUBLESHOOTING

The following simple issues can be handled by the user. Please call the after-sale service department if the issues are not solved.

Problem	Possible reason
Not work	• Whether the freezer is plugged and connected to power;
	• Low voltage
	• Whether temperature control knob is in the work area
	• Failure power or tripping circuit.
Odor	• Odorous foods should closely wrapped;
	• Check whether there is any rotten food
	• Whether the interior shall be cleaned.
Long-term operation of compressor	• It is normal that freezer operates for longer time in summer when the ambient temperature is higher;
	• Do not put too much food in the freezer at one time;
	• Do not put foods until they are cooled;
	• Frequent opening of freezer door;
	• Thick frost layer (defrost is needed).
Light not work	• Whether the freezer is connected to power, whether the light is damaged.
Door can not be properly closed	• The freezer door is stuck by food packages;
	• Too much food;
	• Unbalanced freezer.

Problem	Possible reason
Loud noises	<ul style="list-style-type: none"> <li>Whether the floor is flat, whether the placement of freezer is stable;</li> </ul>
	<ul style="list-style-type: none"> <li>Whether the freezer accessories are properly placed.</li> </ul>
Transient difficulty in door opening	<ul style="list-style-type: none"> <li>After refrigeration, there will be pressure difference between the inside and outside of the freezer to result in transient difficulty in door opening. This is a normal physical phenomenon.</li> </ul>
Over heat on sidewall	<ul style="list-style-type: none"> <li>The freezer enclosure may emit heat during operation specially in summer, this is caused by the radiation of the condenser, and it is a normal phenomenon.</li> </ul>
Surface Condensation	<ul style="list-style-type: none"> <li>Condensation: condensation phenomenon will be detected on the exterior surface and door seals of the freezer when the ambient humidity is high, this is a normal phenomenon, and the condensation can be wiped away with a dry towel.</li> </ul>
Airflow sound Buzz Clatter	<ul style="list-style-type: none"> <li>Refrigerants circulating in the refrigerant lines will produce eruption of sound and grunts which is normal does not affect the cooling effect.</li> </ul>
	<ul style="list-style-type: none"> <li>Buzz will be generated by running compressor specially when starting up or shutting down.</li> </ul>
	<ul style="list-style-type: none"> <li>The solenoid valve or electric switch valve will clatter which is a normal phenomenon and does not affect the operation.</li> </ul>



*make yourself at home*



[www.midea.com](http://www.midea.com)

© Midea 2022 all rights reserved