



Before using your washing machine, please read this manual carefully and keep it for future reference.

# Washing Machine

## OWNER'S MANUAL

### MT725B

#### **Read This Manual**



Inside you will find many helpful hints on how to use and maintain your washing machine properly. Just a little preventative care on your part can save you a great deal of time and money over the life of your washing machine. You'll find many answers to common problems in the chart of troubleshooting tips. If you review the chart of Troubleshooting Tips first, you may not need to call for service.

## Contents







Safety and precautions.....	2
Installation of the washer.....	5
Preparation before washing.....	7
Parts identification of the washer.....	8
Instruction of the washer operation panel.....	9
Quick start.....	11
The main wash.....	12
Special features.....	13
About the procedure of full automatic wash program.....	15
Cleaning and Maintenance of the washing machine.....	16
Identify usual trouble of washer.....	17
Malfunction display and solutions.....	18
Technical specifications.....	18

# Safety and precautions

Observe the following items in order to prevent from injuring yourself, others and the damage of property:

	Warning	This indicates serious injury or death to human being may be caused.
	Caution	This will remind you that injury to people and damage to property may occur.

Please observe following contents of graphics.

	This graphics represents(cause attention), and detailed cautions will be displayed inside the graphics. 
	This graphics represents (operation prohibited), and detailed prohibitive items will be displayed inside the graphics. 
	This graphic represents (forcible execution), and detailed forcible execution items will be displayed inside the graphics. 
	This appliance is not intended for use by persons (including children) with reduced physical, sensory or mental capabilities, or lack of experience and knowledge, unless they have been given supervision or instruction concerning use of the appliance by a person responsible for their safety. Children should be supervised to ensure that they do not play with the appliance.

## Warning

Please do not disassembly and assembly the machine without authorization.

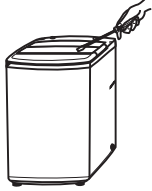

 No dismantling

Please do not insert your hand and take out clothes inside the spin barrel before it is fully stopped.



 No touching

Please do not install the machine in damp and raining environment to avoid electric shocking, catching fire, faults and distortion accidents.



 No dampness

Please do not directly rinse the machine with water when cleaning.



 No rinsing

 **Warning**

Please do not let children climb the machine or peer into the rotating spin barrel to avoid accidents.



Prohibited

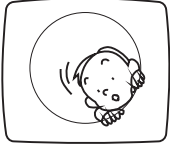

It is prohibited to wash the clothes touching with kerosene, gasoline, alcohol and other flammable materials.



Prohibited



Please do not damage power flexible cord and power plug to avoid electric shocking, short circuit and catching fire.



Prohibited

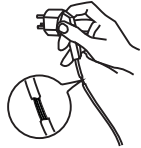

Regularly clean the power plug to remove dust and dirt to avoid contact failure.



Please pull out plug from the socket if the machine is not in use.



Pull out the plug

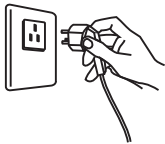

Please well connect the earth line of socket to avoid electric shocking by accidental leakage.

( earthing )



Earthing

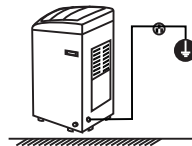

Please insert the power plug tightly.

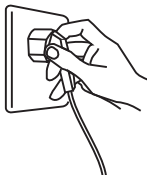

Please do not place on the washer burning candle, mosquito-repellent incense, cigarette and other flammable things, as well as electric stove, air heating fan and other heating sources.



Smoke and fire prohibited



Please use correct power source.



Please do not pull out or insert the plug with wet hands to avoid electric shocking.



Wet hands are prohibited

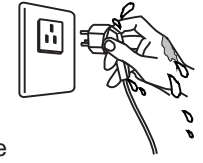

 **Caution**

Please ensure that the water inlet pipe is connected and the tap is opened before washing clothes.

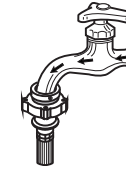

The water temperature shall not exceed 50°C when washing with warm water.



Prohibited



Customers are not allowed to change the power line without permission.



Prohibited



It is strictly prohibited to place and sit children or lay weights on the washer.



Prohibited

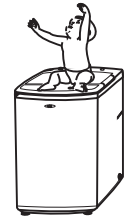

Please do not pull the electric cord when pulling out the plug.



Please do not wash down jacket, raincoat, fishing coat and similar clothes in the washer.



Prohibited



## Installation of the washer

### Remove package

- Remove package and take out the bottom board of the cabinet on the foam cover.
- Open the lid of washer's door and take out accessories.
- A trial operation or washing on the foamed cushion is strictly forbidden.

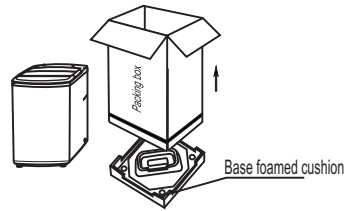

### Installation of drain hose

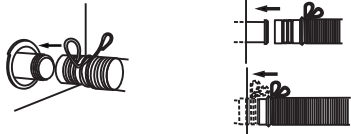

- Completely sleeve the drain hose over the sewer.
- Fix and tighten it with a hoop. (As shown in the figure)

### Placement of water drain hose



If the water drain hose shall be extended, its length shall not exceed 3 meters, otherwise it will affect the water discharging time.

The placed height of water drain hose shall not exceed 15cm.

Do not bend the water drain hose and place it under the washer.

FOR LOWER DRAIN SYSTEM ONLY

### Placement of upper water drain hose

- The height of drain hose ("a") should be between 86-100 cm.
- Diameter of "b" should not be less than 3 cm, and flow capacity not less than 40 L/Min.
- Before washing machine starts, user should hang up the drain pipe 86-100cm height from the floor.

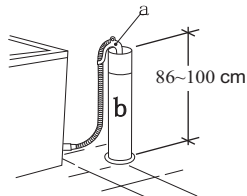

FOR UPPER DRAIN SYSTEM ONLY

### Installation of water inlet pipe

- Put the water inlet pipe (which has metallic filtering bag) screw on to the tap.
- Tightly screw another end of water inlet hose on water inlet valve. (with rubber seal ring inside).

Note: When tightening the clamping nut, evenly apply the force and do not twist the water inlet valve to avoid breaking of water inlet valve joint.

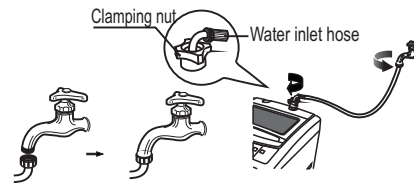

Only for model with double screw thread water inlet pipe

## Installation of the washer

### Installation of water inlet pipe

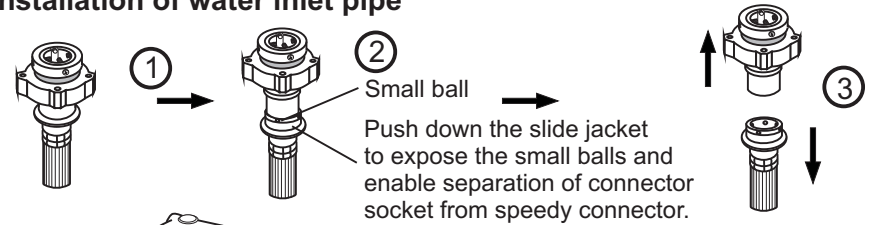

Push down the slide jacket to expose the small balls and enable separation of connector socket from speedy connector.

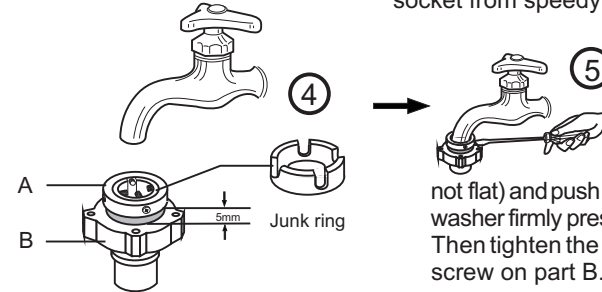

The connection socket consists of A and B two parts. Before installation, A and B two parts must be unscrewed about 5mm, or directly disconnected. If the bore of water tap is larger, remove the plastic junk ring of part A.

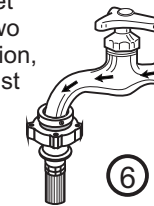

Connect

Unscrew four screws of part A and sleeve part A horizontally over the mouth at the end of water tap (the mouth at the end of water tap must be flat and smooth. Flatten it by filing if it is not flat) and push it upward with force making the rubber washer firmly press the plane center of water tap mouth. Then tighten the screw sequentially. After that, tightly screw on part B.

Connect: Push down the slide jacket of speedy connector (4 small balls must be exposed), insert it into the connection socket and then push upward. Release the connection of water tap with speedy connector completely. If it is required to feed water, simply open the water tap. Separate: Close the water tap, push down the slide jacket of speedy connector and pull out the speedy connector.

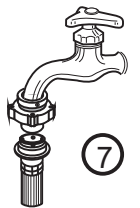

Separate

Tightly screw another end of water inlet hose on water inlet valve. (with rubber seal ring inside).

Note: When tightening the clamping nut, evenly apply the force and do not twist the water inlet valve to avoid breaking of water inlet valve joint.

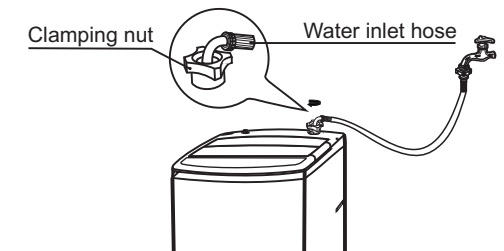

Only for model with single screw thread water inlet pipe



If the supply cord is damaged, it must be replaced by the manufacturer, its service agent or similarly qualified persons in order to avoid a hazard. The instructions for appliances connected to the water mains by detachable hose-sets shall state that the new hose-sets supplied with the appliance are to be used and that old hose-sets should not be reused. The openings must not be obstructed by a carpet. This appliance is for indoor use only.

## Preparation before washing

### 1 Adjust the adjustable foot to make the washer be placed stable.

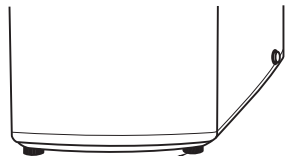

Adjustable foot (extend when clockwise rotating and shorten when counterclockwise rotating)

(Slightly incline the washer first and loosen the adjustable foot knob. Adjust the adjustable foot so as to ensure four corners of washer be steadily contacted with the ground. Then tighten the adjustable foot knob and lock it. If the ground is obviously not flat, correction should be made on the ground surface, otherwise the washer barrel will incline and knock the cabinet)

### 2 Install the water inlet hose.

For one inlet hose

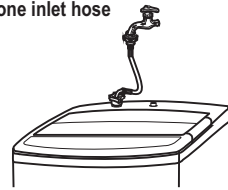

For two inlet hoses

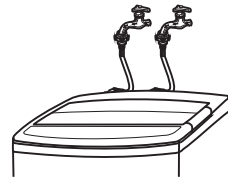

### 3 Connect with to power source.



### 4 Turn on the water supply.

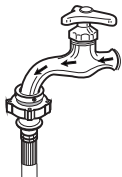

### 5 Put down the drain hose.

Gravity drain

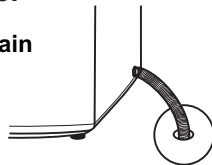

Upper drain

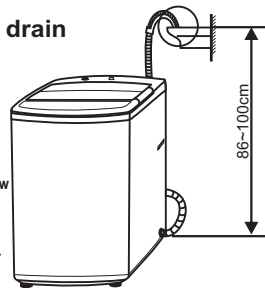

Note:  
The water will overflow when the height of the drain hose under 860mm.

### 6 Put in clothes and suitable amount of washing powder.

**NOTICE** Before washing, please do take out coins, keys and other hard goods, and zip up clothes tightly to prevent them and barrel from damage.



## Parts identification of the washer

Water inlet valve

Door

Control panel

Top cover

Cabinet

Adjustable foot knob

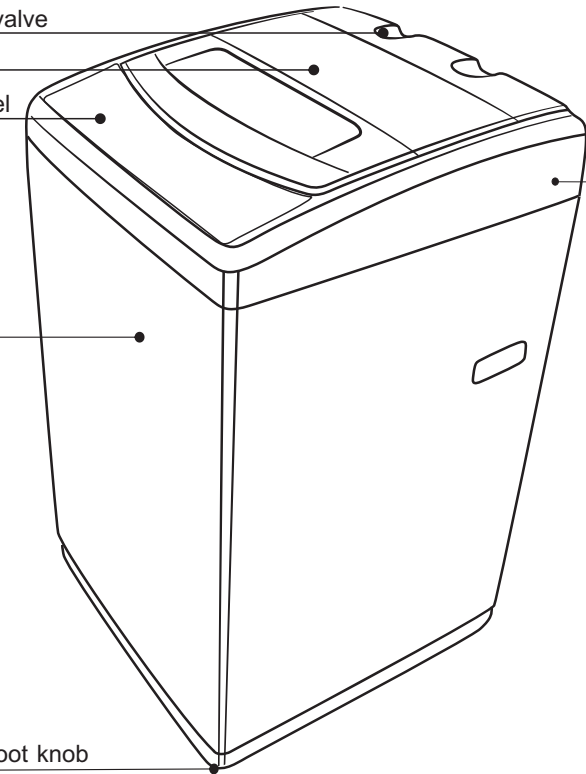

## Accessories

Fixing ring (1) is used for the fixing in time of the installation of the lower drain hose.

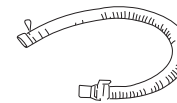

Only for lower drain hose



Universal connector

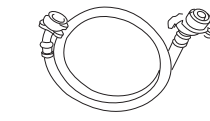

Water inlet hose assembly

Only for model with single screw thread water inlet pipe

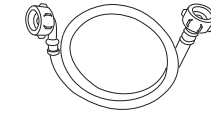

Water inlet hose assembly

Only for model with double screw thread water inlet pipe



Self-tapping screw

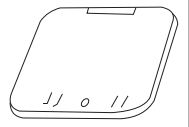

Base cover

Only for models including base cover

Please refer to the real material as the attachment

# Instruction of the washer operation panel

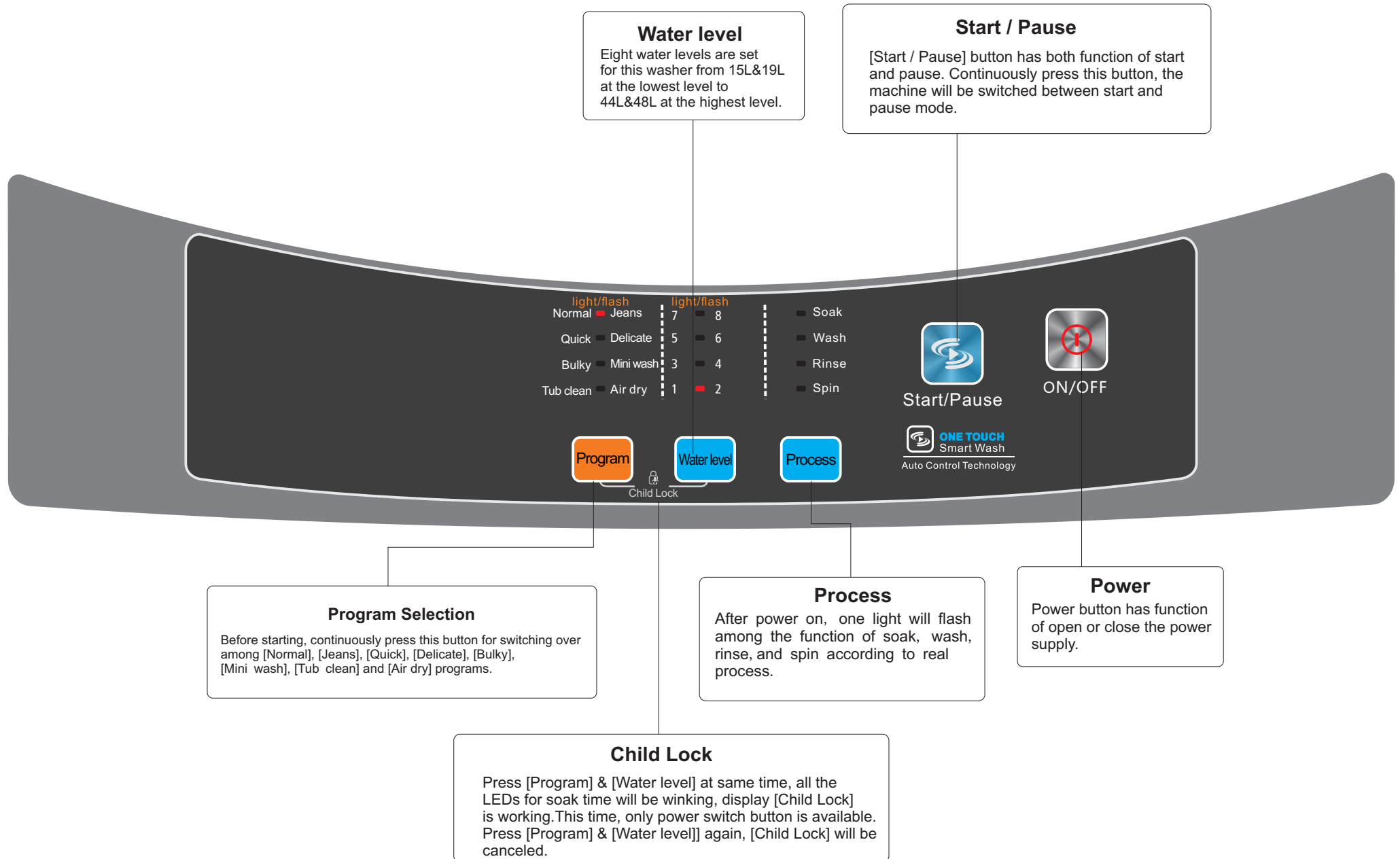

## Quick start

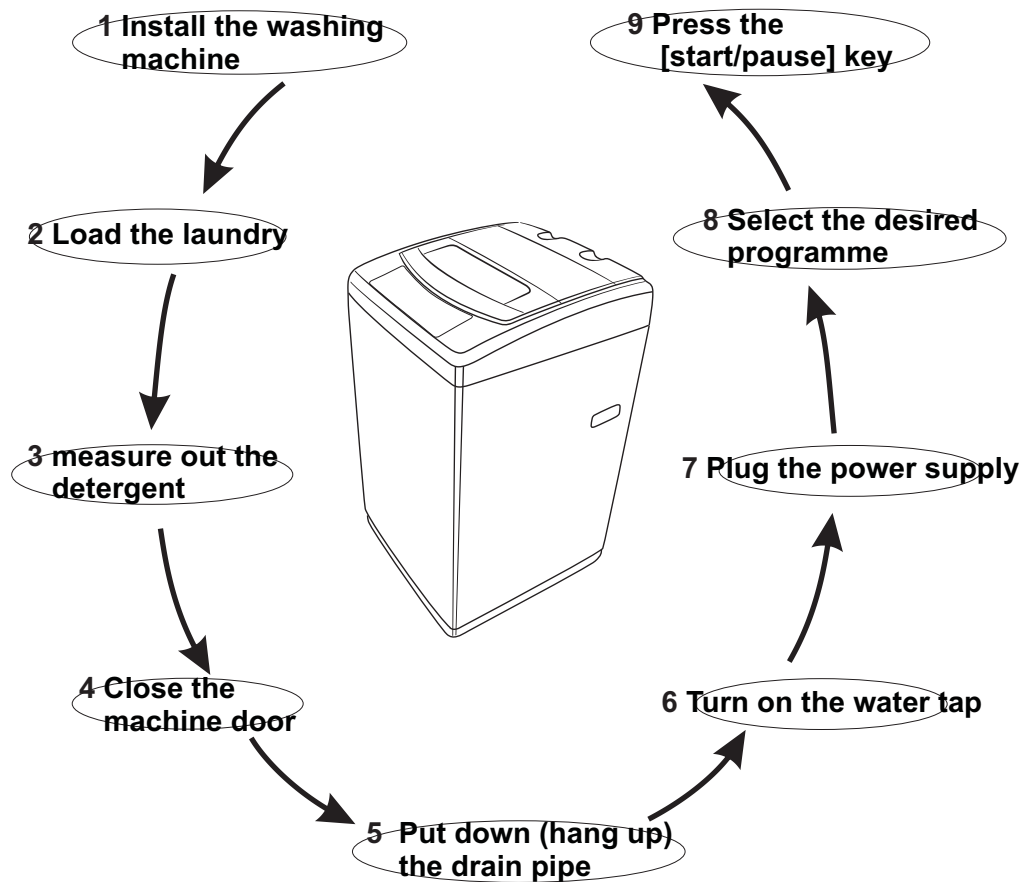

### Programme selection

- 1 Press the "ON/OFF" button.
- 2 Select the proper water level and other attached functions.
- 3 Press the start/pause key.

### The wash stops

- When the wash stops, the buzzer will buzz continuously for 6 times and then the power will be automatically cut off.
- Turn off the water tap.
- Although the power can be cut off automatically, the power plug must be pulled out for the safety.

## The main wash

### Instruction of the NORMAL program

! [Normal] wash program is the easiest, most convenient and most common washing program. When the user presses the power switch and then presses [Start/Pause] button, the normal washing program will start to work.  
Normal program, suitable to wash clothes in spring, autumn, and winter.

### Steps in details

1. Press the "ON/OFF" switch.
2. According to the washing amount choose the proper water level.
3. Press Start/Pause button.

### Instruction to single wash procedure

! User may freely select any single procedure, or any combination of procedures among Wash, Rinse and Spin according to the actual requirements. It is only required to turn off any one or two of these three indicators that are not needed by the user. And keep the indicator on showing the process needed by the user.  
! Single wash -- after switching on the power, turn off Rinse and Spin two indicators by pressing these two keys. The operation for single rinse and single spin is similar.  
! Single wash-spin -- after switching on the power, turn off Rinse indicator by pressing that key. The operation for single rinse-spin and single wash-rinse is similar.

## Special features

---

**Note:** Close the lid of the door when machine is running, otherwise, it will automatically stop working during spin process and send out abnormal warning.

The washer will not work when the filled water does not reach the set water level.

The selection of rinse water level: the level is equal to wash water level.

Press [Rinse Level] button, the indicator light which stand for rinse level flickered.

User can select the rinse water level according to needs. Rinse level exceed that wash level all the time. It shows the wash level if not press this button. And only show rinse level when rinse.

After pressing down [ ON/OFF Switch ], if the [Start / Pause ] button is not pressed, the power will be automatically cut off after 10 minutes.

### JEANS

Water is stronger, suitable for washing cowboy with dirty clothes.

### QUICK

Quick program is used for washing the clothes not so dirty and the whole washing process while use shorter.

### DELICATE

Washing wool clothing. High water level of water level is optional, beat downy.

### BULKY

Washing ability is strong, washing more the dirty clothes.

### TUB CLEAN

Clean the tub. This program can prevent from crossing infection, including wash, rinse and spin a whole process.

## Special features

---

### MINI WASH

Washing a few clothings, low water level, high water level shall not choice.

### AIR DRY

Air dry program is the special program of this washer. The spin barrel circumgyrate in a high speed to make the outside of the barrel dryness. Controlling the bacilli. Making the washing healthier.

**Note:** This program is used for dry the barrel and do not put the clothes in.

- **Fuzzy control function**

Under the "fuzzy" program, the machine automatically detect amount of laundry, and then select water level automatically. If water exists in the tub when starting operation, the machine cancel "fuzzy" control. If users choose water level before starting operation, the machine cancel "fuzzy control" function.

- **Power failure memory function**

If the power supply becomes off suddenly during operation, the machine remembers the current operation state. When power is on, the machine returns to former operation state automatically.

Only for washers having these two functions

### Energy test program description

Energy test program operation:

1. Press the "ON/OFF" switch,
2. According to procedures keys, choose BULKY program.
3. Adjust washing water quantity is highest level,
4. Press the start button



## About the procedure of full automatic wash program

Program \ Contents	Wash Time (minutes)	Spin Time (minutes)	Complete Time (minutes)	Rinsing Times
Normal	12	5	43	2
Jeans	20	5	63	2
Quick (ECO)	3	2	13	1
Delicate	12	Only drain	35	2
Bulky	10	2	39	2
Mini wash	12	5	43	2
Tub clean			4	Spray rinse 1 minute
Air dry		2	5	







ECO program is selected during testing for a normally soiled load at rated load capacity.

Note: The time required will also vary with water pressures of intake pipe, different clothes textures and different water drain conditions.

## Laundry capacity and water level setting

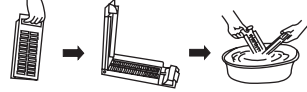
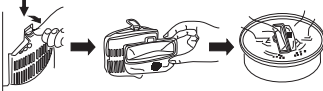
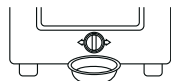
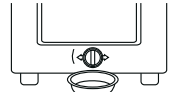
Model	Water level	1	2	3	4	5	6	7	8
MT725B	Weight of laundry(kg)	<0.6	1.2	1.8	2.4	3.0	3.6	4.2	5.0

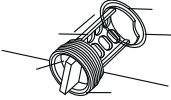
## Cleaning and Maintenance of the washing machine

End of program	Maintenance	
<ul style="list-style-type: none"> <li>The washing machine will send off the sound of "dou-dou" at the end of any program operation to remind you to take out the laundry or operate it again.</li> <li>After the sound, the washing machine returns to its power-off state with no display and all lights off.</li> <li>Please shut off the tap, pull out the plug when not in use to avoid water leakage or the fire accidents.</li> </ul>	<p>Use gentle clothing to wipe off the water and dirt on the surface each time after using the washing machine. Detergent, propellant and other chemicals are not allowed to use so as to avoid any damage to the plastic accessories.</p> 	
Clean the water inlet	Clean Of the filter	
<p>After long time use, the water inlet mesh bag may be blocked with smudginess, and should be cleaned according to the following steps:</p> <ol style="list-style-type: none"> <li>Switch on the power, followed by shutting off the tap</li> <li>Let the washer works for 5 seconds so that water flows into the tub through the water inlet hose, then turn off the power.</li> <li>Unload the water inlet hose and clean the mesh bag, then restore the water inlet assembly.</li> </ol> 	<p>After using the washing machine for a period, please clean it according to the following steps:</p> <ol style="list-style-type: none"> <li>Take out the lint filter.</li> <li>Open the filter and wash it clean in the water.</li> <li>Restore it and fix it.</li> </ol>  <p><b>(only for magic filter)</b></p> <p>After using the washing machine for a period, clean it according to the following steps:</p> <ol style="list-style-type: none"> <li>Take off the lint filter.</li> <li>Turn over the mesh bag and wash it clean in the water.</li> <li>Restore and fix it.</li> </ol>  <p><b>(only for normal filter)</b></p>	
Clean the lint filter in the drain pump (only for having drain filter)		
<ol style="list-style-type: none"> <li>Drain the water out of the pump, under which use a container to collect.</li> </ol> 	<ol style="list-style-type: none"> <li>Loosen the pump cover anticlockwise.</li> </ol> 	<ol style="list-style-type: none"> <li>Take out the lint filter.</li> </ol> 
<ol style="list-style-type: none"> <li>Clean the filter.</li> </ol> 	<ol style="list-style-type: none"> <li>Restore it and adjust the convex place to align at the pump hole.</li> </ol> 	<ol style="list-style-type: none"> <li>Tighten the pump cover clockwise.</li> </ol> 

### Notes:

If the drain filter is not cleaned at proper time (every 10 times of use), Drain problem could be caused.

## Identify usual trouble of washer

When the washer is in trouble, please contact local service office or the sales service department of our company and the customer should not dismantle the machine without permission.

If the washer can not work normally, or appear abnormality or alarms, please check and correct as follows.

### List of faults and inspection

Faults	Inspection Items
No water flows in	<ul style="list-style-type: none"> <li>! If the power is off or the fuse is burned out.</li> <li>! If the water supply is cut off or the water pressure is too low.</li> <li>! If the inlet hose is properly connected and the water tap is opened.</li> <li>! If the filtering screen of inlet valve is blocked by dirt.</li> <li>! If the coil of inlet valve is damaged. (The slight electromagnetic sound is normal phenomenon when the inlet valve is switched on)</li> <li>! If the "Start / Pause" button is pressed after the power switch is pressed.</li> </ul>
No washing	<ul style="list-style-type: none"> <li>! If the power is off or the fuse is burned out.</li> <li>! If the power supply voltage is too low.</li> <li>! If the water amount reaches to the required water level. (The washer will not work if the water amount does not reach the required water level)</li> <li>! If it is set to "Delay" washing mode. (It will only start to work until the reservation time reached)</li> </ul>
Abnormal draining	<ul style="list-style-type: none"> <li>! If the water drain hose is placed very high.</li> <li>! If the end of water drain hose is sealed in pond.</li> <li>! If the internal rubber ring of drain valve is blocked by dirt.</li> </ul>
Abnormal spin	<ul style="list-style-type: none"> <li>! If the door lid is closed.</li> <li>! If all clothing piled largely at one side of barrel or the clothing is excessively placed.</li> <li>! If the washer is not placed in stable condition or it is placed in inclination state. (The ground is not flat).</li> <li>! If the motor belt is loosened.</li> </ul>

Note: During the de spin process, if washing are piled at one side of the spin barrel, it will cause unbalance of spin barrel resulting in striking. At this moment, the computer inside the washer will feel this unbalance phenomenon and will automatically correct it ( fill in water Washing ). However, if unbalance situation is not removed after continuous three corrections, which means the computer auto-correction can not resolve the problem. Then the user has to manually and evenly place the clothing inside the barrel to solve the problem.

## Malfunction display and solutions

When the washer is in trouble, please contact local service office or the sales service department of our company and the customer should not dismantle the machine without permission.

If the washer can not work normally, and the abnormal indication is shown in the nixie tube window or the machine alarms, please check and correct as follows.

Fault	Cause of fault	Indication	Alarm of the buzzing sound	Stopping alarm
Alarm for water inlet	Water injection for about 16 minutes, but do not reach preset water level	The lights of Normal, Jeans Soak and 44L,48L flare.	The buzzer goes on buzzing for 6 seconds. If the fault is not solved, buzzes again for 6 seconds in every 16 minutes.	Open the lid to deal with faults, then close the lid to stop the alarm.
Alarm for opening lid	Open the lid when the washer is spinning.	The lights of Quick, Delicate, Wash and 34L,39L flare.		
Imbalance alarm	Checked imbalance for the third time.	The lights of Bulky, Mini wash, Rinse and 24L,29L flare.		
Drain alarm	After draining for 4 minutes, does not finish draining.	The lights of Tub clean, Air dry, Spin and 15L,19L flare.		

## Technical specifications

Model	MT725B
Rated power supply	220-240V~ 50/Hz
Input power of motor	400W
Rated washing capacity	7.0kg
Rated spin capacity	7.0kg
Overall dimensions	515x525x900(mm)
Application water pressure	0.1MPa~0.6MPa
Weight of whole machine	29kg